

# Formulate Surf Wall

## SURF-WALL

Heavy-duty 50mm aluminum frames are coupled with stretch, zipper pillowcase fabric graphics to create flowing, uniquely-shaped Formulate™ curved walls and architectural structures that are ideal for tradeshows, events, corporate environments and interior spaces. With a variety of options, you can mix and match with other Formulate fabric structures to create the ideal display, booth or environment.

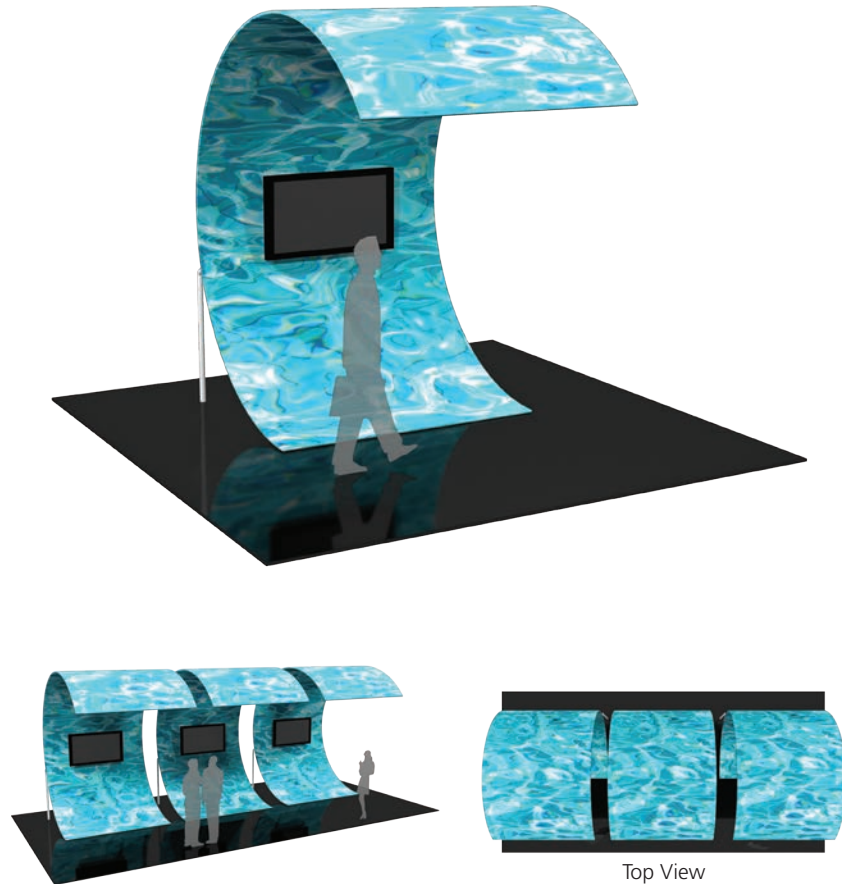

We are continually improving and modifying our product range and reserve the right to vary the specifications without prior notice. All dimensions and weights quoted are approximate and we accept no responsibility for variance. E&OE. See Graphic Templates for graphic bleed specifications.

## features and benefits:

- Heavy-duty 50mm curved aluminum tube frames with support legs
- Organic C-shaped multimedia display
- One wall included. Easily add more surf walls for an even bigger impact!
- Kit includes: one frame, one dye-sublimated zipper pillowcase graphic, large monitor mount, one wheeled molded OCE and one wheeled molded OCH2 storage case
- Lifetime hardware warranty against manufacturer defects

## dimensions:

| Hardware  | Graphic   |
|---|---|
| <p>Assembled unit:<br/>92"w x 136.6875"h x 120.9375"d<br/>2337mm(w) x 3472mm(h) x 3072mm(d)</p> <p>Large monitor mount:<br/>42" / 50 lbs max</p> <p>Approximate weight (includes graphic):<br/>120.57 lbs / 55 kg</p> | <p>Total visual area:<br/>Outside: 92"w x 271.6"h<br/>2337mm(w) x 6899mm(h)</p> <p>Inside: 92"w x 263"h<br/>2337mm(w) x 5994mm(h)</p> <p>Please be sure to include the 5" bleed around the perimeter.</p> |
| Shipping  | Refer to related graphic template for more information.   |
| <p>Shipping dimensions - ships in two cases:<br/>1 OCL case: 19"l x 19"w x 56"h<br/>1 OCH2 case: 52"l x 30"w x 15"h</p> <p>Approximate shipping weight (with cases):<br/>171.57 lbs / 77.8 kg</p>                     | <p>Visit:<br/><a href="http://www.exhibitors-handbook.com/graphic-templates">www.exhibitors-handbook.com/graphic-templates</a></p>  |

## additional information:

Graphic material:  
Dye-sublimated zipper pillowcase fabric

\*Monitor not included



[www.display-setup-animations.com](http://www.display-setup-animations.com)

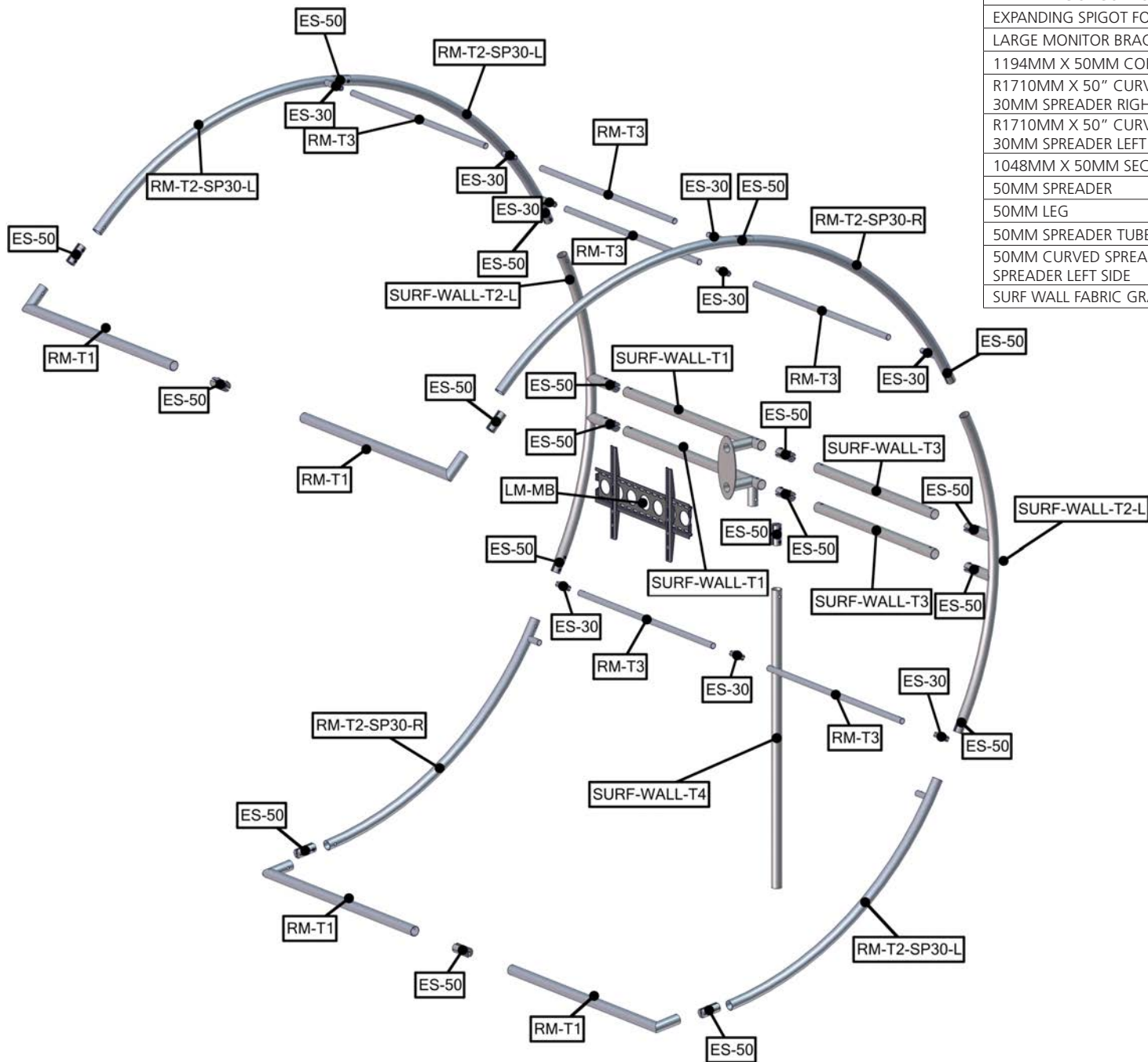

| Parts Included  |     |                |
|---|-----|----------------|
| Part Label  | Qty | Part Code      |
| EXPANDING SPIGOT FOR 30MM TUBE                                  | x9  | ES-30          |
| EXPANDING SPIGOT FOR 50MM TUBE                                  | x19 | ES-50          |
| LARGE MONITOR BRACKET   | x1  | LM-MB          |
| 1194MM X 50MM CORNER SECTION                                    | x4  | RM-T1          |
| R1710MM X 50" CURVED TUBE SECTION WITH 30MM SPREADER RIGHT SIDE | x3  | RM-T2-SP30-R   |
| R1710MM X 50" CURVED TUBE SECTION WITH 30MM SPREADER LEFT SIDE  | x3  | RM-T2-SP30-L   |
| 1048MM X 50MM SECTION   | x6  | RM-T3          |
| 50MM SPREADER   | x2  | SURF-WALL-T3   |
| 50MM LEG  | x1  | SURF-WALL-T4   |
| 50MM SPREADER TUBE WITH MONITOR PLATE                           | x1  | SURF-WALL-T1   |
| 50MM CURVED SPREADER TUBE WITH (2) 50MM SPREADER LEFT SIDE      | x2  | SURF-WALL-T2-L |
| SURF WALL FABRIC GRAPHIC  | x1  | SURF-WALL-G    |

SURF-WALL FRAME ASSEMBLY:

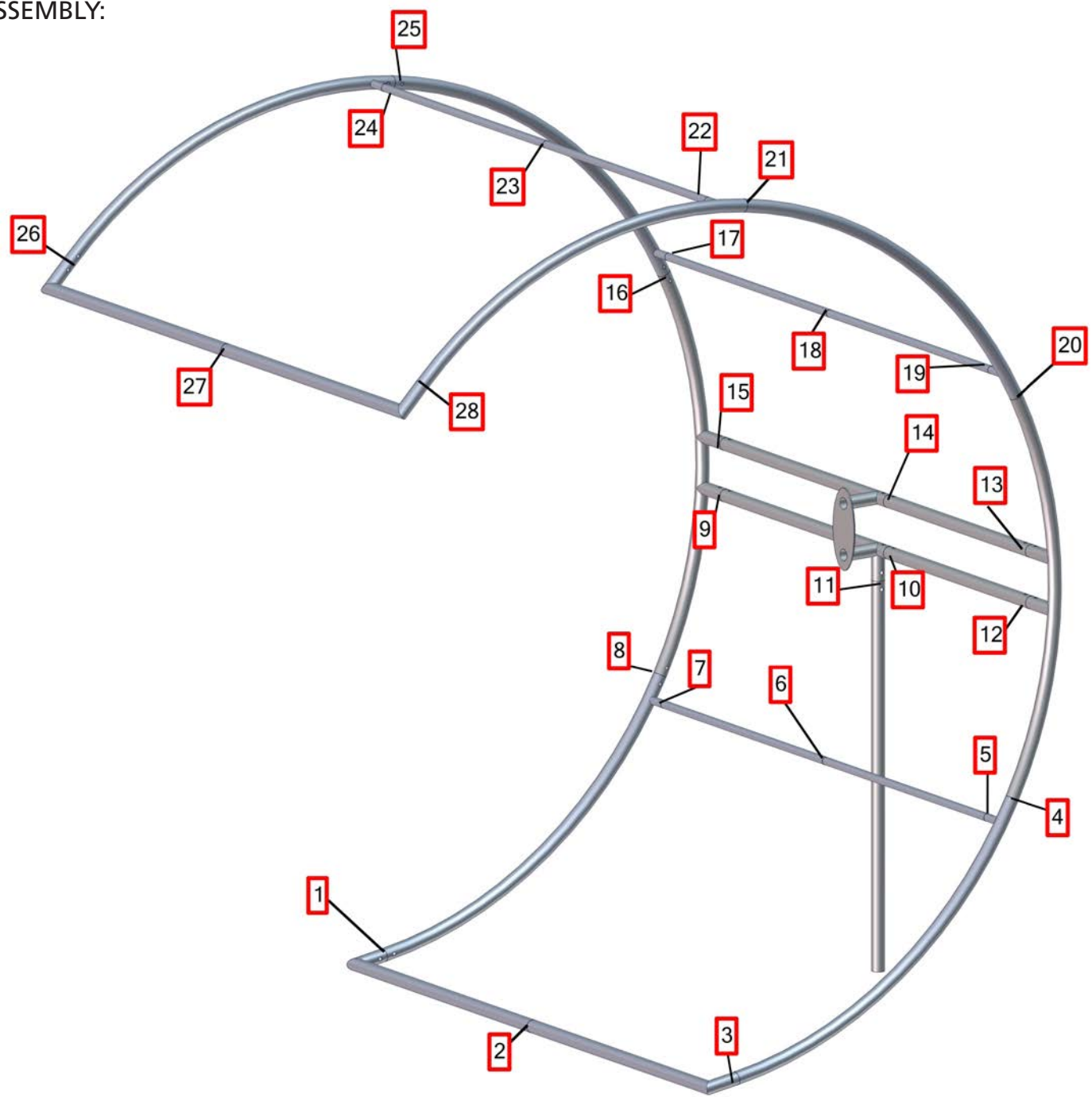

STEP 1: ASSEMBLE FRAME



Connect bottom tubes following the labels matching number to number.

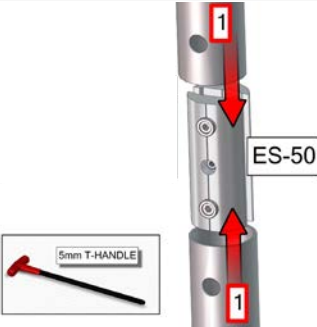

FOR 50MM TUBES: Slide joiner into the tubing so the hex screw sits in the hole on the tubinger.

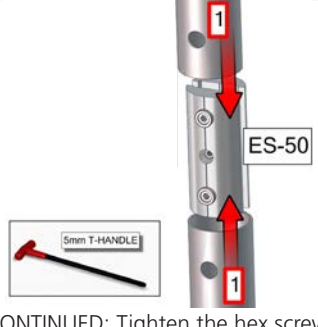

CONTINUED: Tighten the hex screw so the joiner separates and tightens against the inside of the tubing, locking the joiner and tubing together.

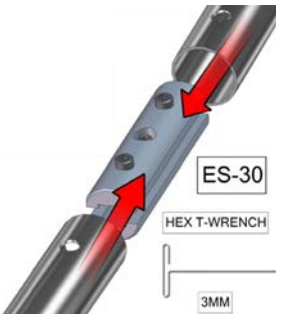

For 30mm tube connection repeat the same steps as ES-50 assembly.

STEP 2: ATTACH GRAPHIC



Connect top tubes following the labels matching number to number.

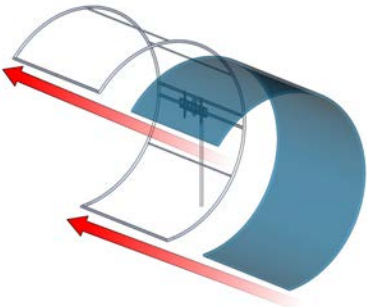

Pull fabric graphic over side of frame.

STEP 3: MONITOR MOUNT

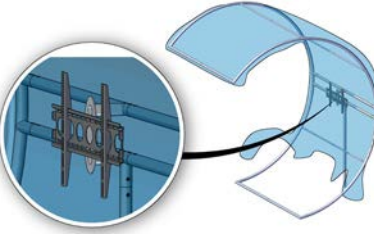

Install monitor mount.

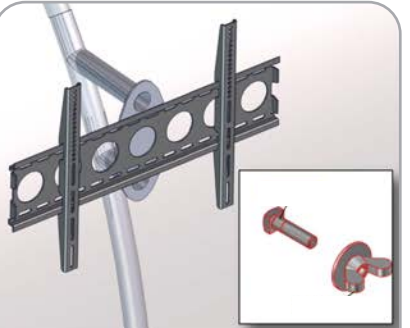

Secure monitor mount to frame with square bolt and wingnut.

STEP 4: ZIP GRAPHIC

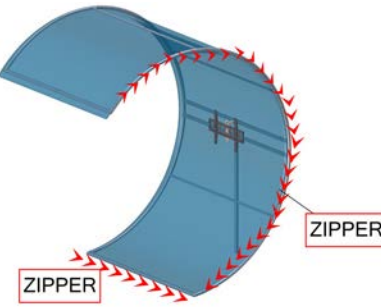

Zip closed along side of frame.