

LUMIÈRE CONFIGURATION - D (NO LIGHTS)

LUMIÈRE LIGHT WALL

PRODUCT CODE: LLW20DNL



On frame On graphic



Shown with optional feet

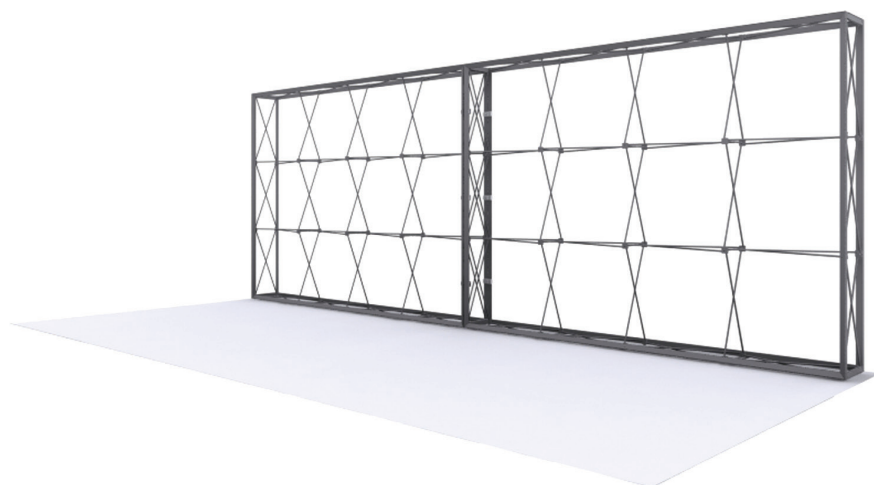

Straight Connector

PRODUCT DESCRIPTION

Introducing the Lumiere Light Wall! A combination of innovative silicone-edge graphics and RPL fabric pop ups offers an easier and more cost effective SEG option. This SEG style display has the depth of the RPL so you can expose more of your message using endcap graphics. The Lumiere shrinks down in size - simply collapse the geometric frame and the SEG bungeed channel bars, and fold or roll the fabric graphics. Setup can be done by 1 person and in 5-10 minutes. SEG portability is easy and stylish.

| | |
|-------------------|------------------------------|
| DISPLAY DIMENSION | 236.2" W x 88.6" H x 14.5" D |
|-------------------|------------------------------|

GRAPHIC DIMENSIONS

| | |
|-------------------|-------------------------------|
| 4X3 MAIN GRAPHICS | 118.5" W x 89" H (4 Graphics) |
|-------------------|-------------------------------|

| | |
|----------------------|-------------------------------|
| 4X3 END CAP GRAPHICS | 14.25" W x 89" H (2 Graphics) |
|----------------------|-------------------------------|

FRAME CONFIGURATION QUANTITY

| | |
|-----------|----------|
| 4X3 FRAME | 2 Frames |
|-----------|----------|

GRAPHIC MATERIAL

Stretch Fabric

GRAPHIC FINISHING

Silicone beading is sewn around the perimeter of the fabric graphic. Silicone beading is hidden from view once installed.

DISPLAY CONSTRUCTION

Aluminum Frame

SHIPPING WEIGHTS & DIMENSIONS

| | |
|--|---|
| 4x3 Lumiere Light Wall (2 boxes total) | |
| Shipping Weight | 35 lbs (frame only) (each box) 39 lbs (with graphics) (each box) |
| Shipping Dimensions | 34" L x 14" W x 9" H (each box) |

GRAPHIC TURN AROUND TIME

2 business days after proof approval

| | |
|--------------|-----------|
| AVAILABILITY | CA and PA |
|--------------|-----------|

LUMIÈRE CONFIGURATION - D (NO LIGHTS)

LUMIÈRE LIGHT WALL
PRODUCT CODE: LLW20DNL

AVAILABLE ACCESSORIES



Lumiere Front Lit -
Black Light LED



Lumiere Front Lit -
Silver Light LED



Lumiere Black Light
(150 W)



Lumiere Silver Light
(150 W)



T135 LED Light



LED Light Bracket



Qty 4 -Stabilization Feet

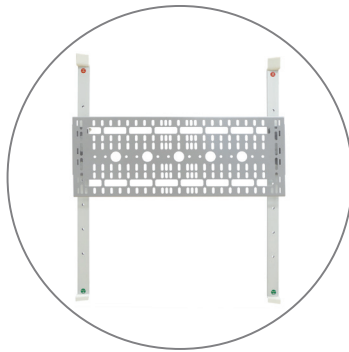

Monitor Bracket

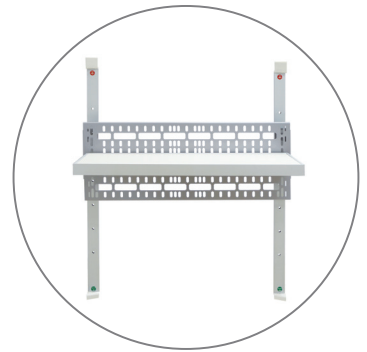

Shelf



Internal Showcase



La Caja Case



Genie Counter Case

LUMIÈRE CONFIGURATION - D (NO LIGHTS)

LUMIÈRE LIGHT WALL
PRODUCT CODE: LLW20DNL

PARTS LIST



Qty 2 - Pop Up Frame



Qty 8 - 4 Section Channel Bars



Qty 8 - 3 Section Channel Bars

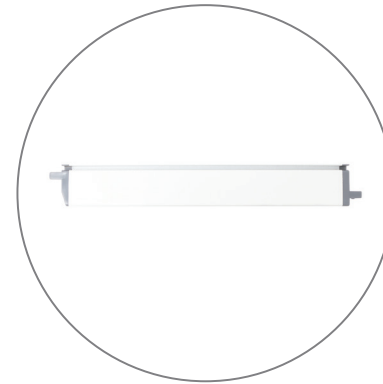

Qty 8 - Top & Bottom Endcaps



Qty 2 - Carry Bags



Qty 2 - Channel Bar Bags



Qty 6 - Straight Connectors

LUMIÈRE CONFIGURATION - D (NO LIGHTS)

LUMIÈRE LIGHT WALL

PRODUCT CODE: LLW20DNL

SET UP INSTRUCTIONS

Set Up Pop Up Frame



a. Place frame with the adjustable feet facing down.

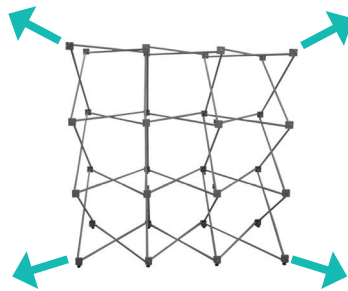

b. Expand the frame.

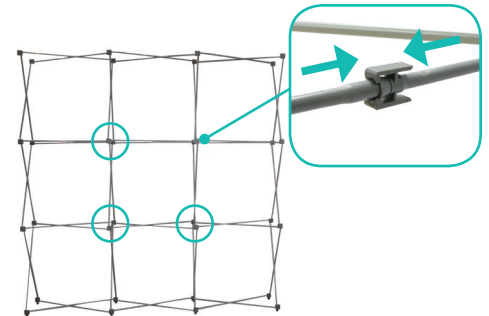

c. Close frame by pushing the outside of the frame until male and female ends connect.

Insert Channel Bars

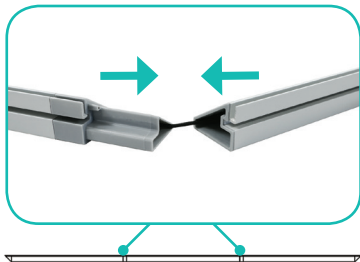

a. Expand each channel bar. Follow bungee to connect.

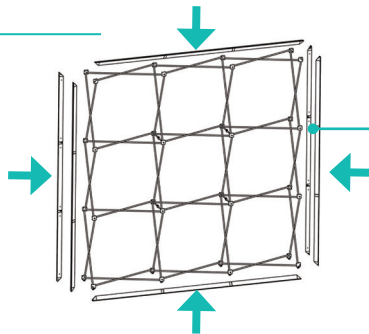

b. Attach channel bars to frame.

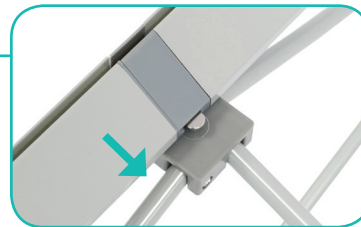

c. Slide channels bars onto frame, from top to bottom, then secure onto metal peg.



d. Attach the top and bottom end-caps on each side of the frame.

Install Graphic



a. In each corner, insert the silicone edge beading into the groove.



b. Then insert the remainder of the beading.



c. Repeat graphic installation on the end caps.

Optional Accessories

Light Bracket:

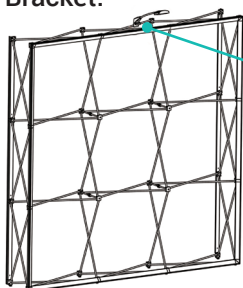

a. Snap the LED Light Bracket on top of the frame. Then slide the LED Light onto the bracket.



Stabilized Feet:

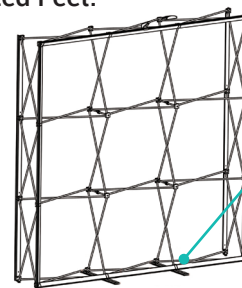

a. From the back, lift frame and insert adjustable feet onto stabilized feet. Then slide stabilized feet toward and insert onto the adjustable feet.

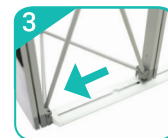
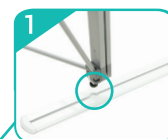

LUMIÈRE CONFIGURATION - D (NO LIGHTS)

LUMIÈRE LIGHT WALL
PRODUCT CODE: LLW20DNL

SET UP INSTRUCTIONS

Connecting Wall

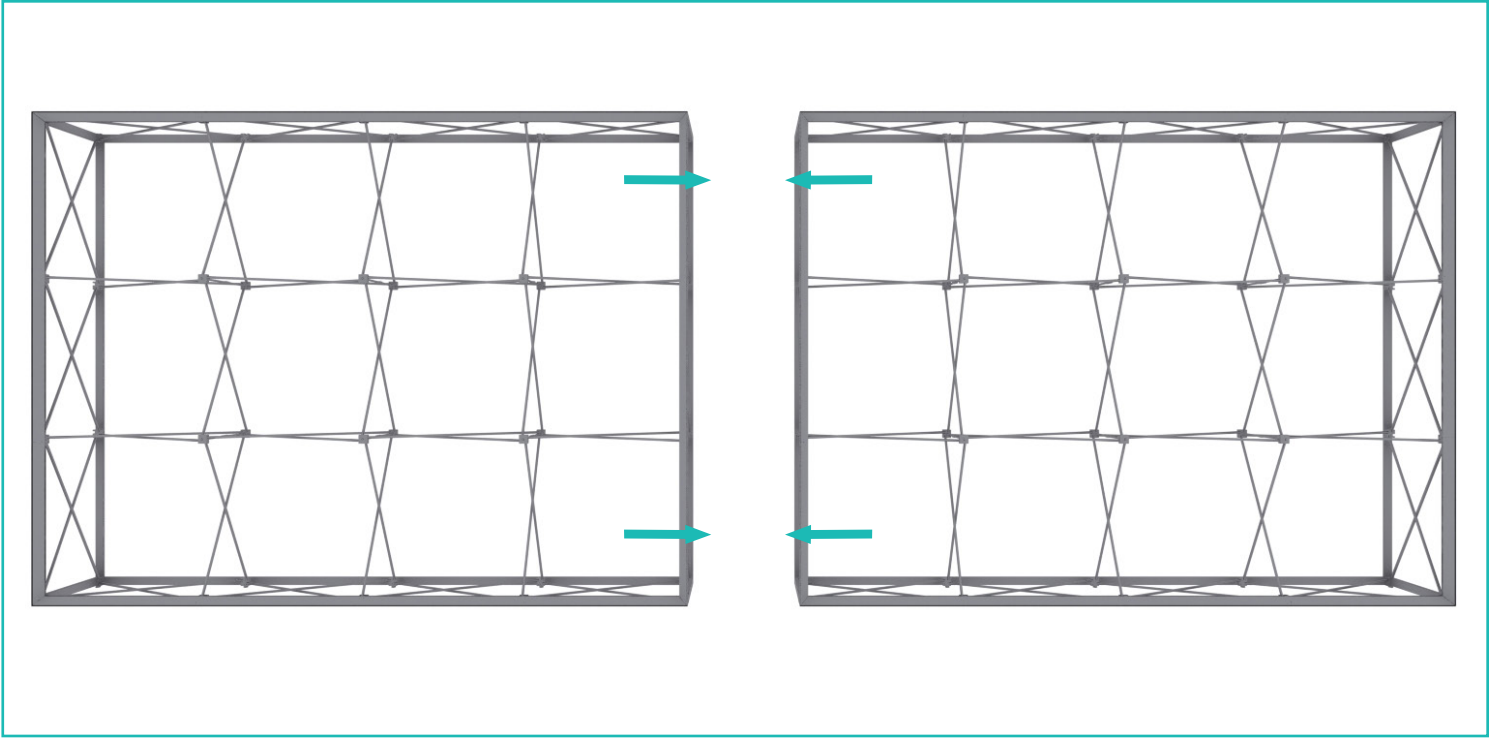

Place the (2) 4x3 frames side by side.

Note: Rendering shown without graphics for clarity.

Straight Connection



1
*Starting from behind, make sure the frames are flushed next to each other.

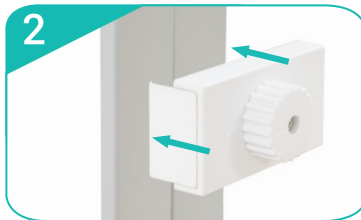

2
Slide Straight Connector onto the channel bars of both frames.

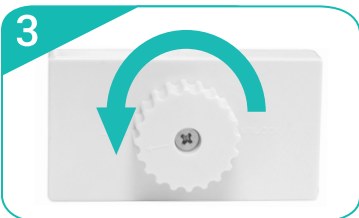

3
Turn dial to the left to lock the Straight Connector in place. Repeat for each vertical sections (6 total).



4

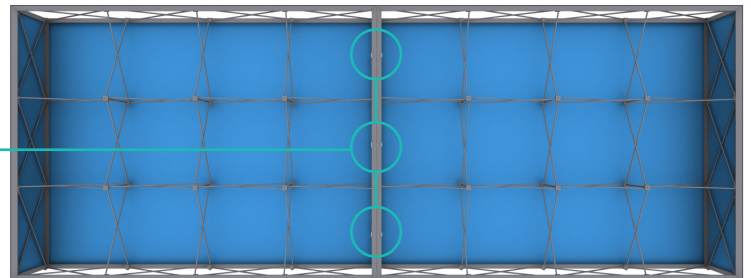

*Back side of the 4x3's shown above.

LUMIÈRE CONFIGURATION - D (NO LIGHTS)

LUMIÈRE LIGHT WALL
PRODUCT CODE: LLW20DNL

TEMPLATE GUIDE

Front View

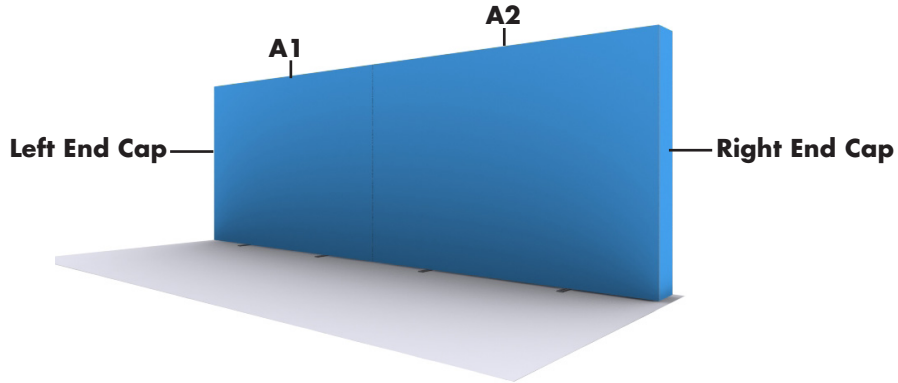

Back View

