

Hanging Banner 14' Pinwheel 60"

SETUP INSTRUCTIONS

Frame 1 - Reference the diagram and steps 1-4.

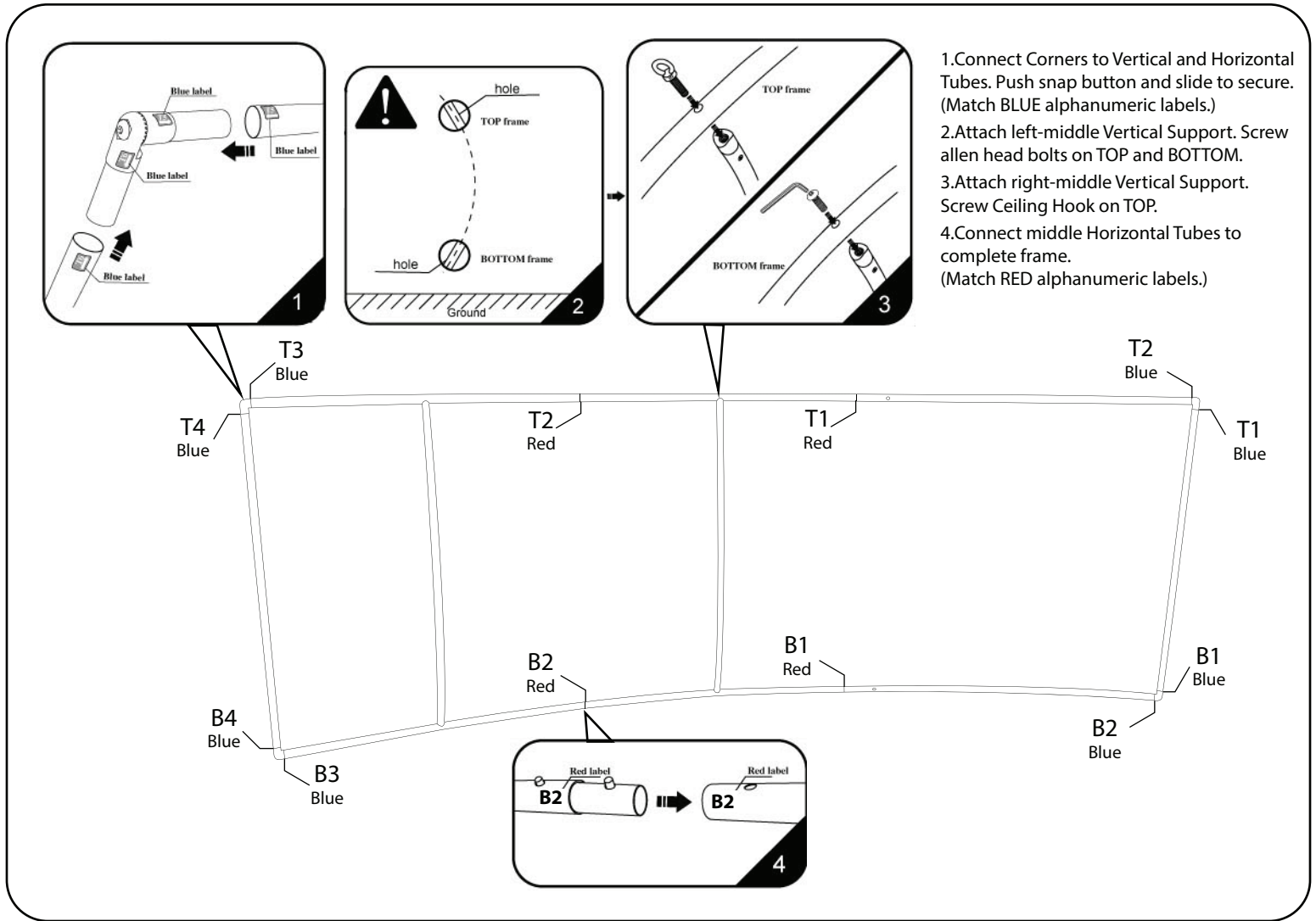

Frame 2 - Reference the diagram and repeat steps 1-4 (from frame 1).

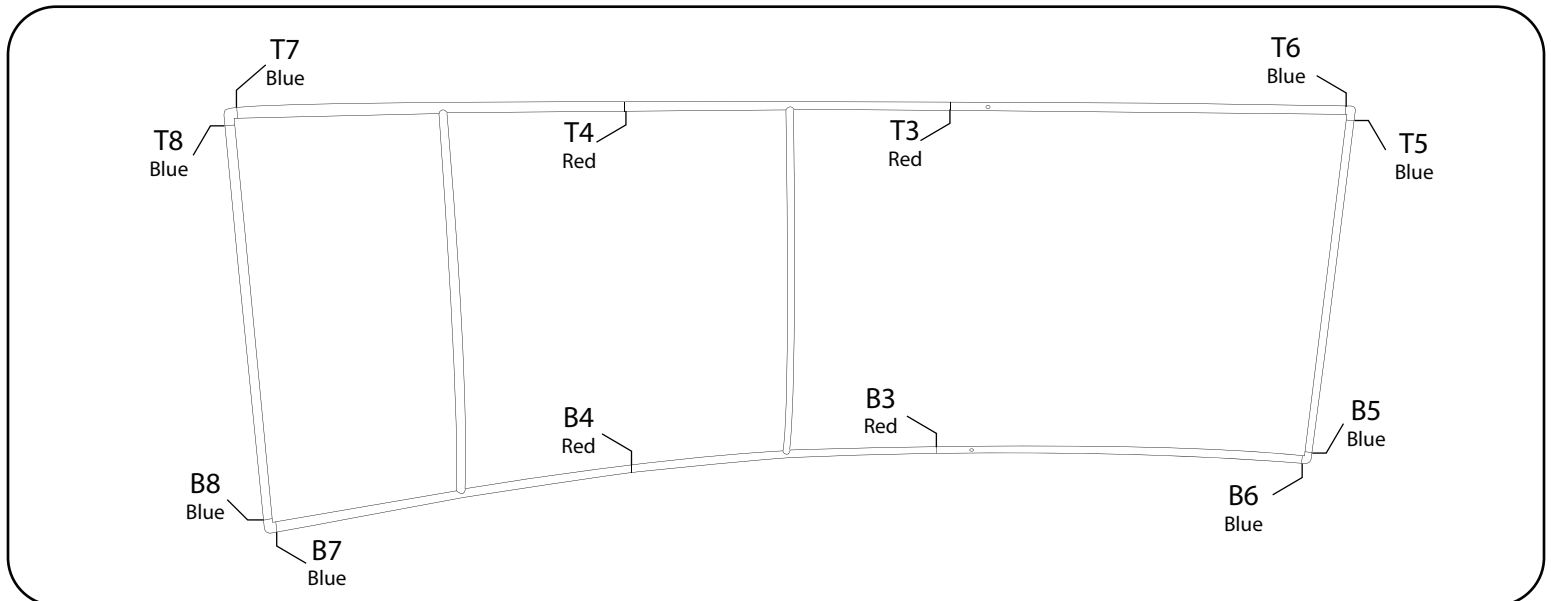

Hanging Banner 14' Pinwheel 60"

SETUP INSTRUCTIONS

Frame 3 - Reference the diagram and repeat steps 1-4 (from frame 1).

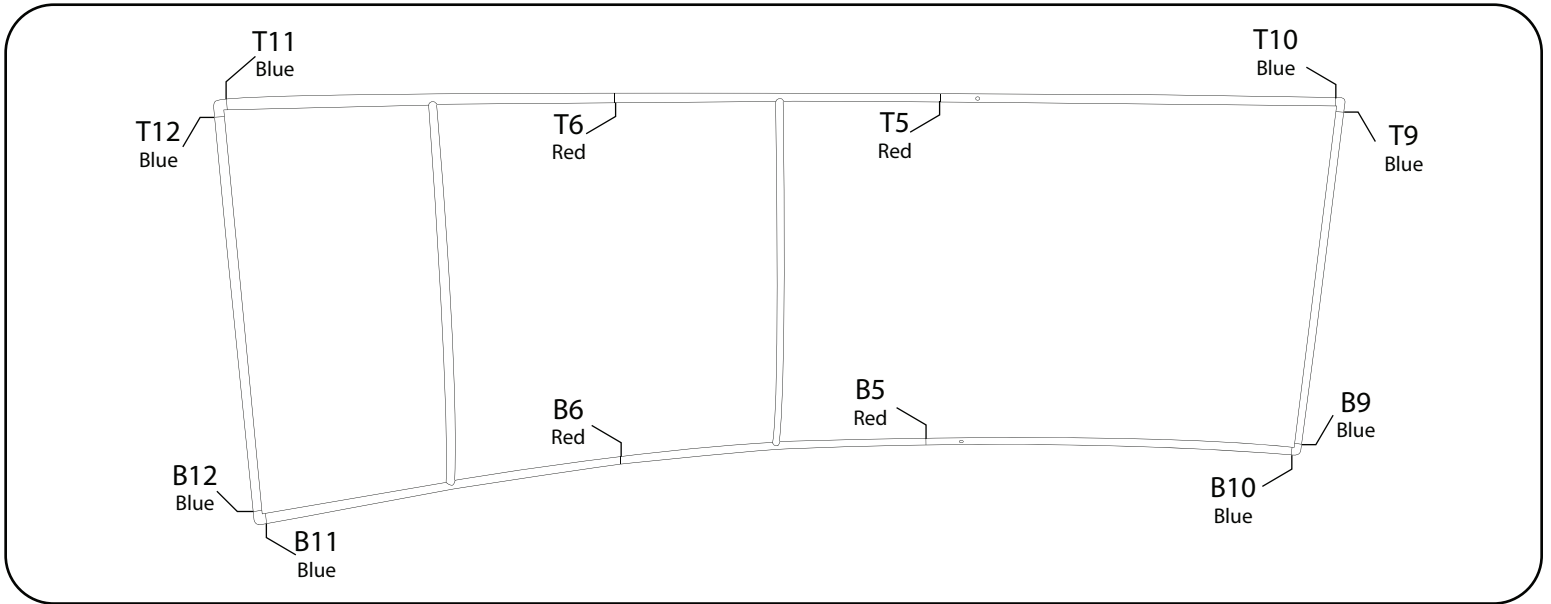

Graphic installation - Slide on graphic, from the bottom up. Pull up graphic until taut and then zip shut to secure. Graphics should be on the concaved side of the frame. Repeat for other frames.

Pinwheel Assembly - Align frame ends as shown below, concave (graphic) side out. Remove the allen head bolt, then slide it back through the opening on the adjacent frame. Use the supplied 2.25" allen head bolts. Repeat on all sides, top and bottom.

