

# BIG SKY TOWER 60D - 6FT X 16FT (BACKLIT)

RESORT EXTRUSIONS

PRODUCT CODE: BIGSKYT60D6X16-LLFRM

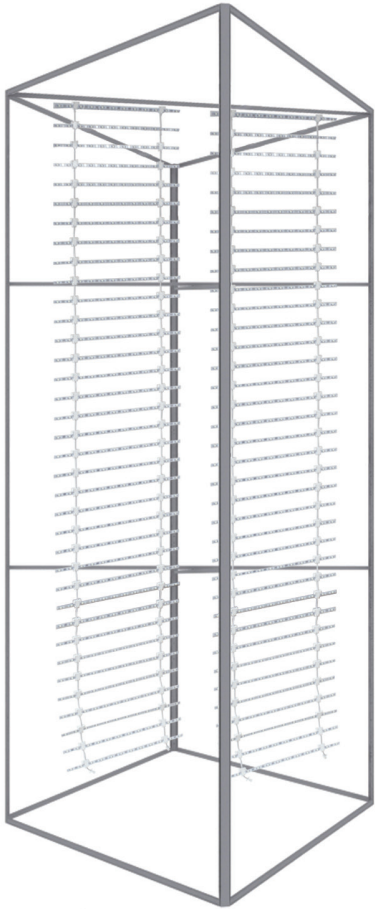

# BIG SKY TOWER 60D - 6FT X 16FT (BACKLIT)

RESORT EXTRUSIONS

PRODUCT CODE: BIGSKYT60D6X16-LLFRM

## SET UP INSTRUCTIONS 1/2

### 1. Attach Split Connectors to Side Extrusions:

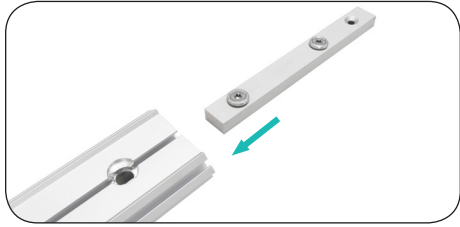

**a.** Remove the screw and insert split connector into one end of the extrusion. Match like colored numbers together. (e.g. 3-3, 4-4).

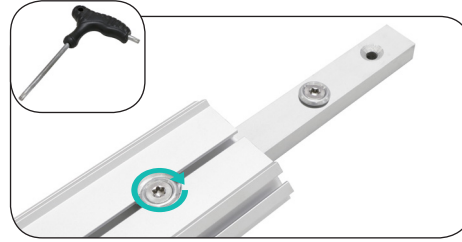

**b.** Tighten screw to lock it into place. Remove the remaining screw from the connector.

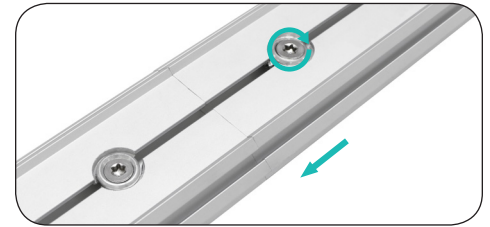

**c.** Then slide the other extrusion onto split connector. Make sure extrusions are flush and tighten the screw to secure connection.

### 2. Attach Split Connectors to Bottom & Top Horizontal Extrusions:

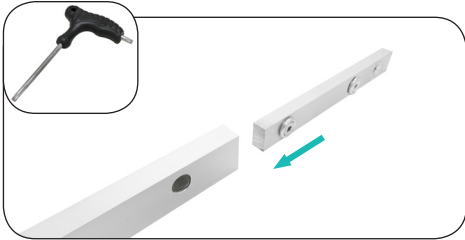

**a. Split Connector:** Remove the screw and insert split connector into one end of the extrusion.

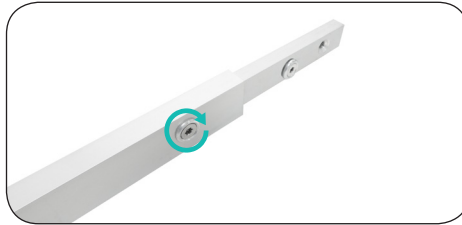

**b.** Tighten screw to lock it into place. Remove the remaining screw from the connector.

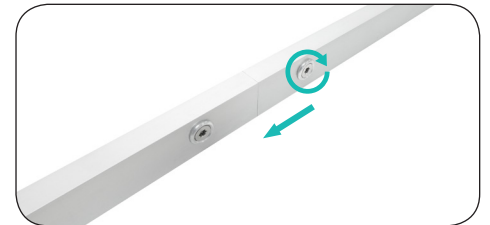

**c.** Then slide the other extrusion onto split connector. Make sure extrusions are flush and tighten the screw to secure connection.

### 3. Locate the Bottom and Side Extrusions:

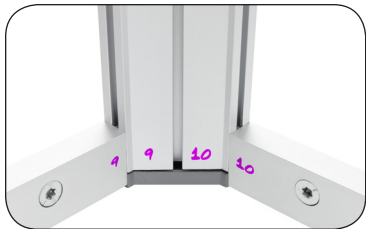

**a.** See colored numbers on each extrusion piece. Match like colored numbers together. (e.g. 3-3, 4-4).



**b.** End Lock is already attached to opposite ends of extrusion.



**c.** Connect horizontal extrusion to the bottom of a vertical extrusion, screw facing inward.



**d.** Connect bottom extrusions together and use torx key to tighten.

### 4. Locate the Top and Side Extrusions:

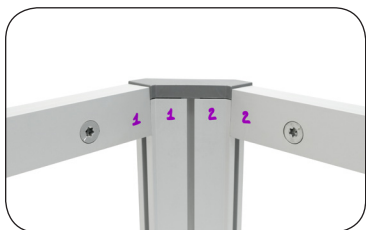

**a.** See colored numbers on each extrusion piece. Match like colored numbers together. (e.g. 3-3, 4-4).



**b.** End Lock is already attached to opposite ends of extrusion.

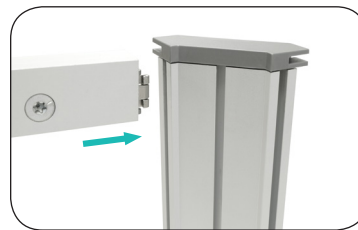

**c.** Connect horizontal extrusion to the top of a vertical extrusion, screw facing inward.



**d.** Connect the top extrusions together and use torx key to tighten.

# BIG SKY TOWER 60D - 6FT X 16FT (BACKLIT)

RESORT EXTRUSIONS

PRODUCT CODE: BIGSKYT60D6X16-LLFRM

## SET UP INSTRUCTIONS 2/2

### 5. Build Support Struts:

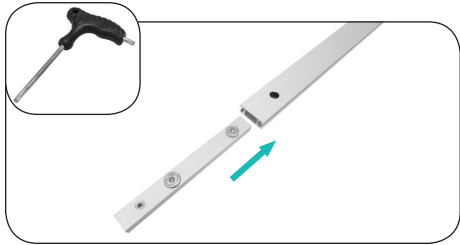

**a.** Remove screws from Center Connector.

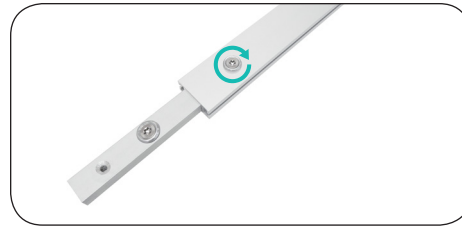

**b.** Insert Center Connector and align holes with holes on extrusion.

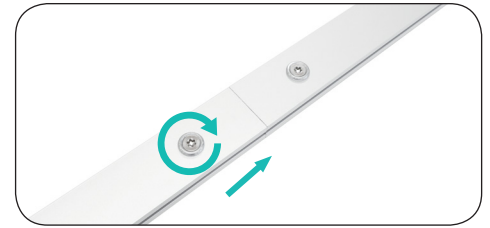

**c.** Repeat to connect other extrusion to make one long piece.

### 6. Attach Support Strut to Frame:

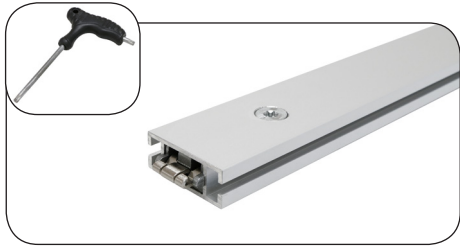

**a.** End Lock is already attached to opposite ends of Support Strut.

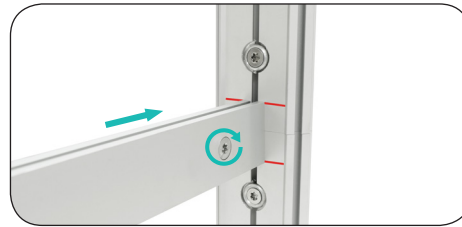

**b.** Align Support Struts within marked lines, and insert End Lock into top and bottom grooves of frame.

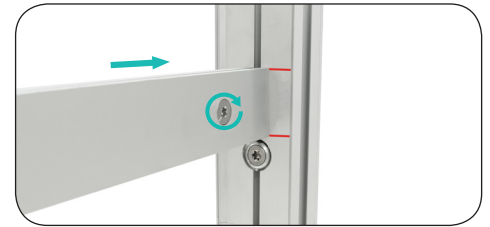

**c.** Add a second support strut to align marked lines and tighten screws with **torx key** to secure connection.

### 7. Attach Light Hooks:

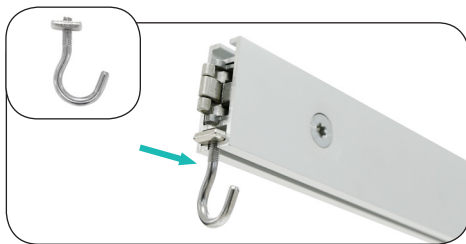

**a.** **Eye Hooks:** Insert light hooks into the groove in one end of the extrusion.

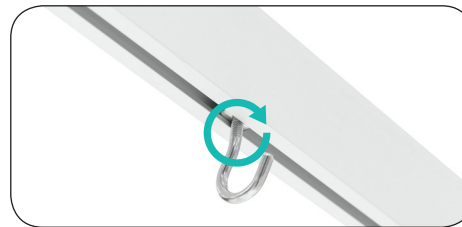

**b.** Slide the light hooks into the groove and place them in the center. Tighten Hook.

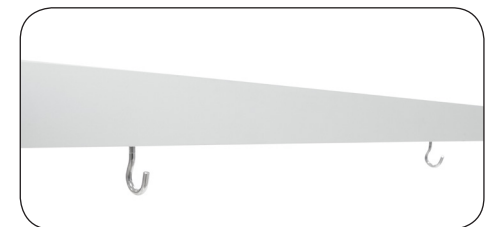

**c.** Make sure light hooks are placed far apart for hooking the LED Ladder Lights.

### 8. Hook Ladder Lights:

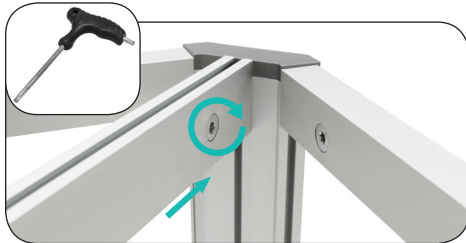

**a.** Place extrusion with the light hooks on top of the extrusion and connect together.



**b.** Hang ladder LED lights on hooks and drape them down inside the wire.

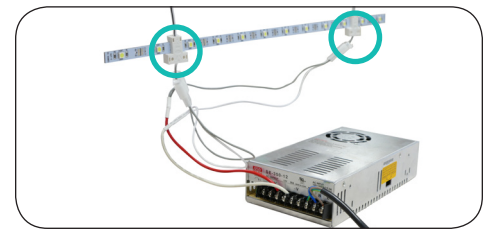

**c.** The transformer comes pre-wired. Connect the wiring from transformer to the 2 plugs at the bottom of the ladder lights.